

PHYSICAL DIMENSIONS:

- A 3.05 [.120] ± 0.08 [.003]
- B 2.54 [.100] ± 0.08 [.003]
- B<sub>1</sub> 3.05 [.120] ± MAX
- C 8.51 [.335] ± 0.23 [.009]
- C<sub>1</sub> 9.53 [.375] ± MAX

WIRE DIMENSIONS:

- T<sub>1</sub> 1.27 [.050] ± 0.05 [.002]
- T<sub>2</sub> 1.52 [.060] ± 0.51 [.020]

# 28F0121-1SR-10

**UNCONTROLLED DOCUMENT**

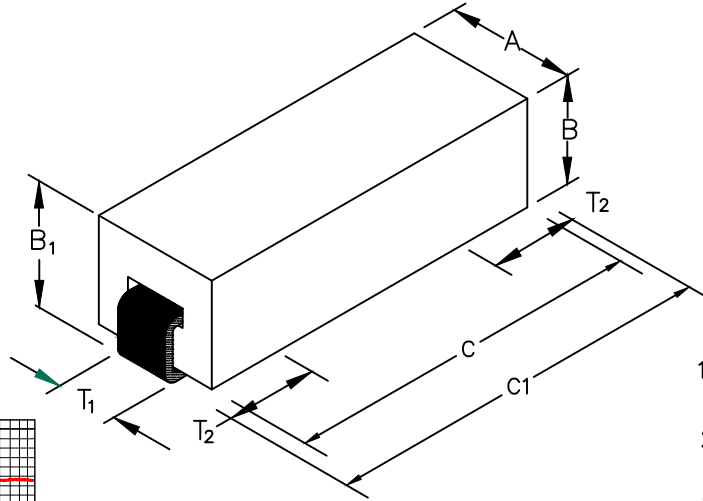

ELECTRICAL CHARACTERISTICS:

Z @ 100MHz (Ω)	DCR (Ω)	Rated Current
Nominal	96	
Minimum	72	
Maximum	.001	10,000 mA

NOTES: UNLESS OTHERWISE SPECIFIED

1. TAPED AND REELED per CURRENT EIA SPECIFICATIONS 13" REELS, 2500 PCS/REEL.
2. COMPONENTS SHOULD BE ADEQUATELY PREHEATED BEFORE SOLDERING.
3. REF. CARRIER TAPE SPECIFICATION # CART121-13.

Z vs. FREQUENCY  
IMPEDANCE UNDER DC BIAS

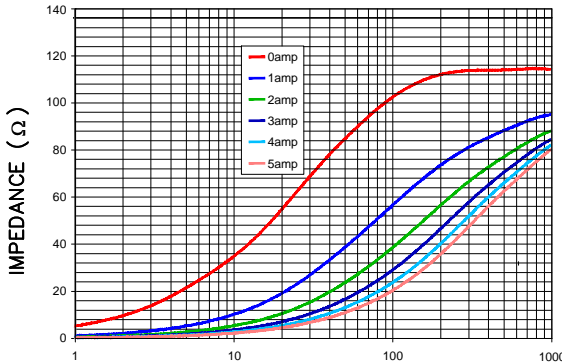

FREQUENCY (MHz)

|Z|, R, AND X vs. FREQUENCY

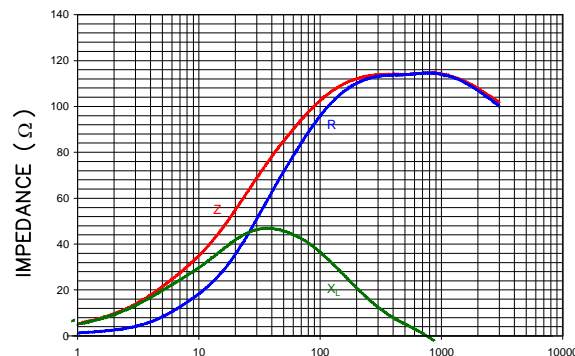

FREQUENCY (MHz)

Z R X<sub>L</sub>

LAND PATTERNS FOR REFLOW SOLDERING

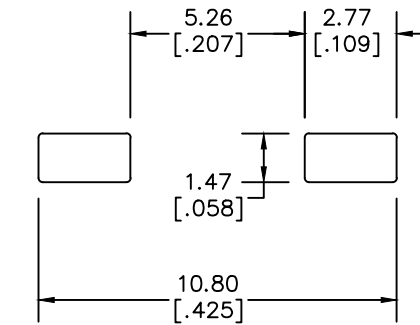

(For wave soldering, add 0.762 [.030] to this dimension.)

RECOMMENDED SOLDERING CONDITIONS

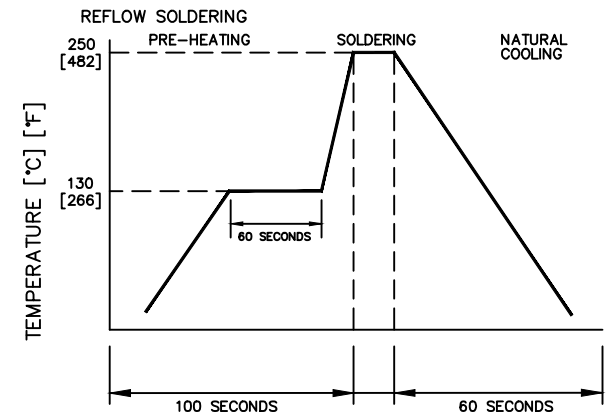

DIMENSIONS ARE IN mm [INCHES]				This print is the property of Laird Tech. and is loaned in confidence subject to return upon request and with the understanding that no copies shall be made without the written consent of Laird Tech. All rights to design or invention are reserved.		<b>Laird</b>		
G	UPDATE LOGO	04/23/15	QIU					
F	UPDATE COMPANY LOGO	10/24/08	JRK					
E	UPDATE LANDPATTERN ADD ROHS SYMBOL	08/09/07	JRK					
D	UPDATE COMPANY LOGO	04/19/07	JRK					
C	ADD KGS TO WGT&LBS TO PART WGT	09/13/05	JRK					
B	CHANGE RATED CURRENT FROM 5000mA	02/17/04	JRK					
A	ORIGINAL DRAFT	10/06/03	JRK					
REV	DESCRIPTION	DATE	INT					
				PROJECT/PART NUMBER: 28F0121-1SR-10		REV G	PART TYPE: ASSEMBLY	DRAWN BY: JRK
				DATE: 10/06/03		SCALE: 10 : 1		SHEET: 1 OF 2
				CAD # 28F0121-1SR-10-1-G		TOOL # H0121		